

GOLDI_66GN Polycrystalline Module

Key Features

- Excellent module conversion efficiency of up to 17.12%.
- Up to +3% positive power output guaranteed.
- Reducing equipment loss increases the power generation in overall system.
- Loss minimization due to excellent temperature co-efficient.
- BOS cost reduction for 1500 VDC System by connecting more modules in a string.
- Better performance even at low irradiance condition.
- Higher specific yield.

Quality & Reliability

- Manufactured in an ISO 9001:2015, ISO 14001:2015 & OHSAS 18001:2007 certified facility.
- Manufactured using high grade raw materials from reputed international suppliers adopting a stringent quality criteria.
- PID resistant (IEC 62804).
- Salt mist and ammonia corrosion resistant. (IEC 61701 & IEC 62716).
- IP67 rated junction box for long-term weather endurance.
- 25 years output warranty.
- Certified for hail resistance.
- Certified for IEC & BIS.

Technical Data for GOLDI_66GN - Polycrystalline Module

Electrical Parameter at STC

Module Type	GOLDI066FPY24			
Capacity rating - Pmax(Wp)	290	295	300	305
Power Tolerance (%)	0 - 3	0 - 3	0 - 3	0 - 3
Module efficiency (%)	16.27	16.55	16.84	17.12
Rated voltage - Vmp(V)	33.82	34.12	34.42	34.72
Rated current - Imp(A)	8.58	8.65	8.73	8.8
Open circuit voltage - Voc(V)	42.3	42.5	42.8	43.1
Short circuit current - Isc(A)	8.96	9.02	9.09	9.15

Under Standard Test Conditions (STC) of irradiance of 1000 W/m², spectrum AM 1.5 and cell temperature of 25°C.

Electrical Parameter at NOCT

Capacity rating - Pmax(Wp)	215.63	219.32	223.30	227.05
Rated voltage - Vmp(V)	31.31	31.59	31.87	32.15
Rated current - Imp(A)	6.89	6.94	7.01	7.06
Open circuit voltage - Voc(V)	39.53	39.72	40.00	40.28
Short circuit current - Isc(A)	7.23	7.27	7.33	7.38

NOCT irradiance of 800 W/m², ambient temperature of 20°C, Wind speed 1m/sec

Guarantees and certifications

Product warranty**	10 years
Performance guarantee**	Limited warranty for power output :- 90% for 10 years, and 80% for 25 years
Product Certified	IEC 61215, IEC 61730, IEC 61701, IEC 62716, CE, BIS

Mechanical specification

Solar cells	66 pcs Polycrystalline Silicon, 5BB/4BB
Encapsulation	Ultra - clear PID free EVA (Ethylene-Vinyl-Acetate)
Backside	UV protected reflective backsheets
Frame	Silver Anodized Aluminium Alloy (screwless)
Front glass	3.2 mm, High Transmission, AR Coated Tempered Glass
Dimensions	(L)1800 mm x (W)990 mm x (H)35 mm
Weight	20.2kg
J-box	IP 67 certified 4-rail, 3 diodes junction box
Cable	Solar cable 400mm to 1200 mm length, 4 mm ²
Connectors	MC4 compatible connectors
Application Class	Class A
Electrical Safety	Class II
Fire Safety	Class C (Type 1)
Surface load	(snow load 5400 Pa, wind load 2400 Pa).

Temperature Coefficients (TC)

Temperature Coefficient (Voc)	-0.31% /°C
Temperature Coefficient (Isc)	0.05% /°C
Temperature Coefficient (Pmax)	-0.38% /°C

Permissible Operating Conditions

Temperature range	-40°C to + 85°C
Maximum system voltage	1500/1000 VDC
NOCT	45 ± 2°C
Hail resistance	Maximum diameter of 25 mm with velocity 23 m/s

IV Curves

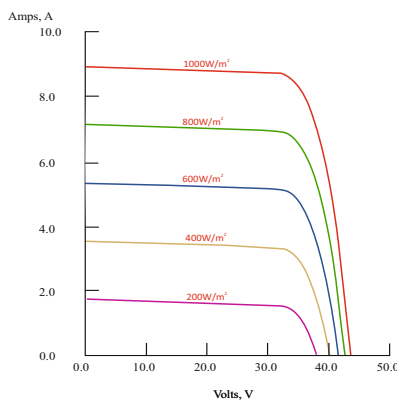

Drawing measurement in mm

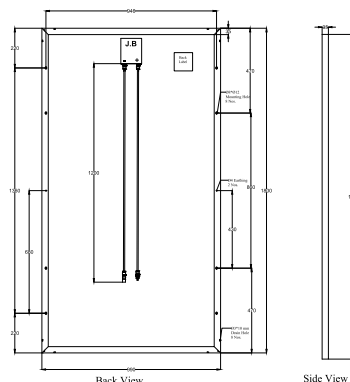

Container	20' GP	40' HC
Pallets/ container	12	28
Modules / Container	360	840

- For handling & installation instructions refer Goldi Solar Installation Manual
- Dispose-off the product as E-Waste after end of its working life.
- ** Refer to Goldi Solar's warranty document for terms and conditions.
- Due to constant product modifications, Goldi Solar reserves the right to amend the above specifications without prior notice.